

# Rooms

that deliver

## Summit Conference Centre

Situated on the first floor, the Cedar and the Willow Rooms are inter-connecting while the Chestnut Room is located opposite.

### Cedar Room

This room has superb views overlooking the hotel's extensive grounds and 100 year old cedar tree. The Cedar Room can seat up to 16 boardroom style.

- Internet
- Natural daylight
- Views

### Willow Room

The Willow Room is suitable for a maximum of 12 delegates.

- Internet
- Natural daylight

### Chestnut Room

The Chestnut Room can also seat up to 16 delegates and overlooks the hotel's grounds.

- Internet
- Natural daylight
- Views

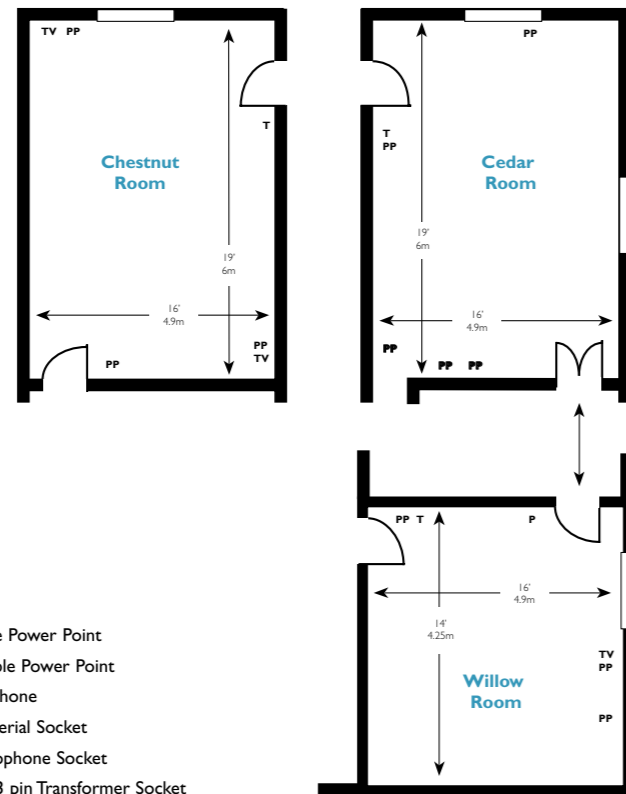

|                          | Willow | Cedar | Chestnut | Library |
|--------------------------|--------|-------|----------|---------|
| Floor location           | 1st    | 1st   | 1st      | Ground  |
| Theatre                  | 12     | 24    | 24       | 12      |
| Classroom                | 8      | 14    | 14       | 8       |
| Boardroom                | 10     | 16    | 16       | 10      |
| U-shape                  | 10     | 16    | 16       | 10      |
| Reception/buffet         | -      | 14    | 14       | 10      |
| Dinner                   | -      | 14    | 14       | 10      |
| Height (m)               | 3.04   | 3.04  | 3.04     | 3.04    |
| Obstacles (i.e. pillars) | no     | no    | no       | no      |
| Windows                  | yes    | yes   | yes      | no      |
| No. 13 amp sockets       | 7      | 10    | 6        | 4       |
| Phone points             | 1      | 1     | 1        | 1       |
| Internet                 | yes    | yes   | yes      | yes     |



## Conference Desk

For details of over 350 conference rooms across more than 40 locations call

0844 815 9050

or visit

[www.ramadajarvis.co.uk/summit](http://www.ramadajarvis.co.uk/summit)



## Ramada Bristol North, The Grange

An elegant country house set in its own landscaped gardens dating back to 1851. Only minutes from the M4, M5 and M32. The hotel is the ideal location for conference and corporate events alike.



Ramada Bristol North, The Grange  
 Old Gloucester Road  
 Northwoods  
 Winterbourne  
 Bristol  
 BS36 1RP

Tel: 0844 815 9063 Fax: 01454 777447

Email: [csales.plazabristol@ramadajarvis.co.uk](mailto:csales.plazabristol@ramadajarvis.co.uk)

[www.ramadajarvis.co.uk/grange](http://www.ramadajarvis.co.uk/grange)

[www.summitconferences.co.uk](http://www.summitconferences.co.uk)

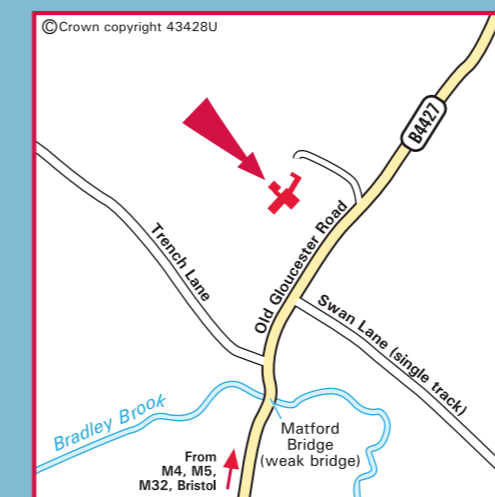

### Location

North east of Bristol city centre and only minutes from Bristol Parkway mainline station. Accessible from J16 of the M5 and J1 of the M32.



# Conferences

that deliver *from the start...*



At Ramada Bristol North, The Grange, the Summit Conference Centre comprises 6 conference rooms suitable for hosting discreet boardroom meetings or conferences for up to 150 delegates.

## Flexible to Your Needs

The hotel's business services and conference facilities will meet the highest expectations with your meeting room set up exactly to your specifications. There is a variety of equipment available to hire for your meeting, simply let us know what you need and we'll arrange it for you.

## One Contact

From your initial enquiry through to the day of your meeting, your Summit Sales Executive will be your one contact. They will take the details of your conference, as well as any changes you make once it has been booked and ensure that everything is exactly as you want it. That means you have one dedicated contact who knows you and understands your event.

## Communication

The communication continues through to the event and beyond. Where possible, we'll introduce you to the hotel operations team who'll be looking after your event so you have met them before the day.

## Summit Ambassador

Your Summit Ambassador will be in reception to meet and greet you on arrival.

## Summit Host

Once introduced to you, your Summit Host is your on the day contact. They will show you to your meeting room, double check all your details with you and be available to help with anything else you may need throughout the day.

### 68 bedrooms

### 56 doubles

### 10 twins

### Free parking for 120 cars

### Summit Conference Centre

### Largest meeting room holds 150 delegates

### Sebastian Coe Health Club

### Conservatory Bar

### Located 3 miles from M4/M5 interchange

- Designated car parking and accessible entrance for disabled guests

- Induction loop available for hearing impaired

- Infra red hearing enhancement for hearing impaired

- Wheelchair access throughout most of the hotel

- Specially adapted bedrooms for disabled guests

# Conferences

that deliver *on the day...*

## Summit Direct Button

For assistance throughout the day, just press your Summit Direct button in your meeting room and your Summit Host will be there to help.

## Summit Toolbox

What's more, you'll find within your meeting room the Summit Toolbox, perfect for any stationery bits and pieces you may need throughout your meeting, there's also secretarial support available should you require it.

## Summit Smart Technology

Your guarantee that the equipment supplied by us, will be checked prior to your arrival to ensure it's in full working order. If there is a problem with the equipment throughout the day that we're unable to rectify, we'll give you your equipment hire money back.

Free high-speed internet connections are now available in all Summit meeting rooms.

## Summit Food Choice

We realise that the food and beverage offering is an integral part of any successful meeting and so we have created a versatile Summit hospitality package that gives you the *food that you want to eat, where you want to eat it and when you want to eat it...*

We offer fresh and seasonal products to ensure you get the full flavours you deserve and a range of healthy food choices with no compromise on variety or taste.

## All Summit Conference Day Delegate Rates Include:

- Principal meeting room hire
- Flipchart with paper and pens
- Stationery holder containing notepads, pens and name cards
- Fresh seasonal fruit basket
- Complimentary sweets on every table
- Chilled water and Elderflower cordial
- Unlimited freshly brewed self help tea, coffee, hot chocolate and speciality beverages available in the room or a designated breakout area and at specified times
- Morning breakout basket containing an assortment of snacks
- 2 course lunch in the restaurant or choice of one of four working buffet lunches or sandwich lunch in your meeting room
- Afternoon tea/coffee with a selection of cake slices
- VAT at the current rate

## Summit Lunches

A selection of lunches are available to suit your needs...

## Summit Sandwich Lunch

If all you want is a light lunch, we have a choice of delicious freshly made sandwiches with chips and a healthy fresh fruit platter and while you're at it why not add a mug of soup. All of which can be served in the room or in a breakout area.

## Summit Working Lunch

A range of working lunches designed to be served in the conference room or a designated breakout area featuring a selection of sandwiches, wraps, finger food, vegetarian selections, a range of salads and a selection of desserts.

## Summit Restaurant Lunch

A selection of hot and cold buffet menus, salads and desserts served in the restaurant, featuring dishes such as: lasagne, beer battered haddock, pan-fried salmon, chilli prawns, cod and pancetta fish cakes and grilled Cumberland sausages.

## 24 Hour Delegate Rates

These include all the features of the Day Delegate rate plus:

- 3 course dinner
- Overnight accommodation
- Full traditional breakfast
- Use of leisure facilities where available.

## Summit Extras

These can be ordered and served in your meeting room.

- Bacon, sausage or vegetarian bap
- Mini Danish pastries or croissants
- Healthy fresh fruit platter
- Individual tubs of real dairy ice cream
- Mug of soup
- Chilled 2 pint jug of orange juice
- Chilled 2 pint jug of 100% pure fruit smoothie
- Chilled bottle of still or sparkling Highland Spring water
- Summit 'Salad to go' - choose from either a Goats' cheese, Poached pear, Salmon or Chicken Caesar salad with a fresh fruit selection.

## Relax and Unwind

Enjoy a drink in the friendly surroundings of The Conservatory Bar

## Sebastian Coe Health Club

At the Sebastian Coe Health Club you will find a swimming pool, spa bath, sauna and, exercise equipment if you want to work out.

# Conferences

that work...

## Summit Invoice

We'll log any extras that have been needed throughout the day, which you will sign for, thereby ensuring there won't be any unknown extras on your bill. Once the conference is completed, your bill will be sent directly to you, exactly as requested.

## Feedback

Once the conference is over your Summit Sales Executive will call you to see how everything went.

## And There's More...

Of course, it's not just conferences that we're renowned for, whether you're booking a wedding or other celebration, why not give us a call. With the services of an experienced Special Event Co-ordinator, we can ensure your event is one to remember. For more information or to book a Wedding or Event call 0844 815 9063 or visit [www.ramadajarvis.co.uk/grange](http://www.ramadajarvis.co.uk/grange)

# Rooms

that deliver...

With a choice of 6 meeting rooms, there's a meeting room for you, whatever your requirements. Floor plans and dimensions for each room are detailed below:

## Park Suite

With its own private bar, the Park Suite is the Grange's largest room with two patio doors opening onto its own courtyard. It can accommodate up to 150 delegates

- Air conditioning
- Natural daylight
- Wheelchair access

## Park Avenue and Park Side

Both the Park Avenue and the Park Side can accommodate 60 delegates

- Air conditioning
- Natural daylight
- Wheelchair access

| Floor location           | Park Suite | Park Avenue | Park Side |
|--------------------------|------------|-------------|-----------|
| Theatre                  | G          | G           | G         |
| Classroom                | 150        | 60          | 60        |
| Boardroom                | 72         | 30          | 30        |
| U-shape                  | 76         | 38          | 38        |
| Reception/buffet         | 64         | 33          | 33        |
| Dinner                   | 180        | 80          | 80        |
| Dinner Dance             | 150        | 60          | 60        |
| Height (m)               | 140        | 40          | 40        |
| Obstacles (i.e. pillars) | 2.44-2.99  | 2.44-2.99   | 2.44-2.99 |
| Windows                  | no         | no          | no        |
| No. 13 amp sockets       | yes        | yes         | yes       |
| Phone points             | 22         | 8           | 14        |
| Internet                 | 3          | 2           | 1         |
|                          | yes        | yes         | yes       |

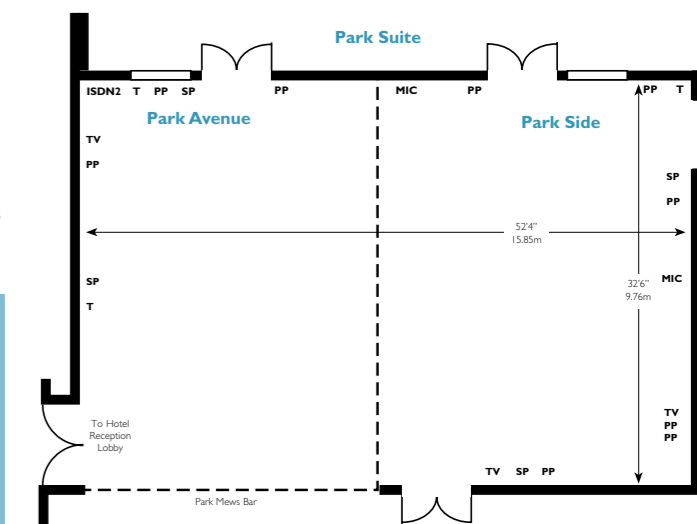

### Key

- SP - Single Power Point
- PP - Double Power Point
- T - Telephone
- TV - TV Aerial Socket
- MIC - Microphone Socket
- ISDN2 - 3 pin Transformer Socket